

E2101-02

timber beam floor, REI 30



classification report

classification report/test certificate - HF Austria
A1973/2009/8
#443/2014/32-BB

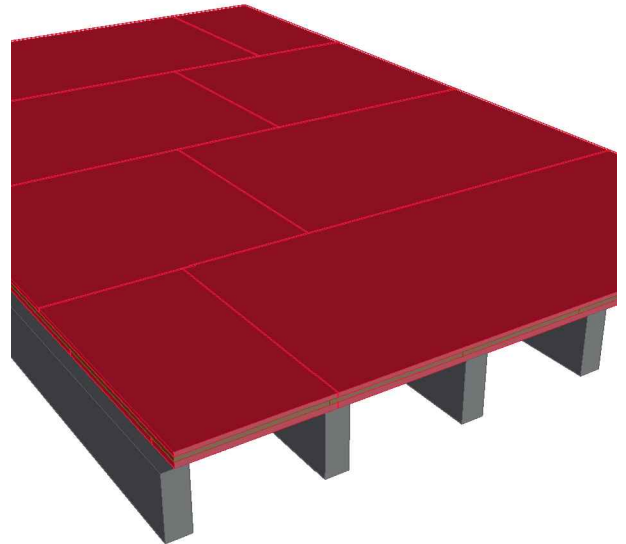

	construction material	dimension / thickness
A	EGGER OSB 4 TOP	18 mm
B	woodfibre insulation $\geq 250 \text{ kg/m}^3$	30 mm
	stone wool impact sound insulation; 30 kg/m^3 , $s' < 15 \text{ MN/m}^2$	-
C	EGGER OSB 4 TOP	30 mm
D	ceiling beams; cc-span = 750 mm	180 × 240 mm

cross-section; 1:10

