

# E2202-02

## Timber beam floor, REI 30

	classification report	classification report HF Austria A1973/2009/6 #443/2014/30-BB
	airborne sound insulation R'w ;DIN 4109-Beiblatt 1, Tabelle 34, Zeile 1	-
	impact sound insulation L'n,w DIN 4109-Beiblatt 1, Tabelle 34, Zeile 1	-

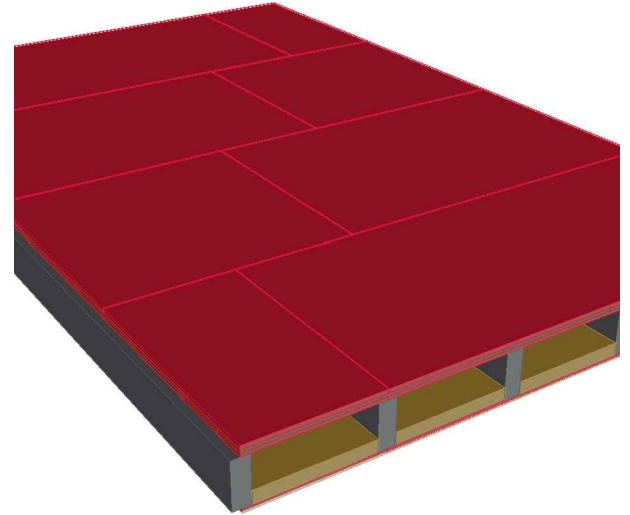

	construction material	dimension / thickness
<b>A</b>	<b>EGGER OSB</b>	-
<b>B</b>	impact sound insulation; 30 kg/m <sup>3</sup> , s' < 15 MN/m <sup>2</sup>	-
<b>C</b>	<b>EGGER OSB</b>	<b>22 mm</b>
<b>D</b>	stone wool; 30 kg/m <sup>3</sup>	200 mm
<b>E</b>	<b>ceiling beams; testload of 3,65 kN/m<sup>2</sup> at cc-span ≤ 625 mm, l ≤ 5.000 mm</b>	<b>80 × 220 mm</b>
<b>G</b>	<b>EGGER OSB</b>	-
<b>F</b>	<b>lathing a ≤ 500 mm</b>	<b>22 × 100 mm</b>
<b>G</b>	plasterboard fire protective	12,5 mm
<b>H</b>	plasterboard fire protective	12,5 mm

cross-section; 1:10

